

## Precision Half Spherical Lamps

Line No.	Part No.	Volts	Amps	Lumens	Color Temp. Degrees Kelvin	Life Hours	Vacuum Or Gas	Filament Type	Filament Dimensions Lgth. x Dia.	Base Type	Drawing
1	L1008	2.5	0.340	2.7	2,230	30,000	V	C-6	1.2 x 0.4	Brass	A
2	L1009	3.5	0.450	4.5	2,230	30,000	G	C-6	1.2 x 0.4	Brass	A
3	L1027	3.5	0.600	24.0	2,850	100	Krypton	C-6	1.2 x 0.4	Brass	A
4	L1031	3.5	1.200	40.0	2,950	150	Halogen	C-6	1.2 x 0.6	Brass	A
5	L1010	5.0	0.160	3.5	2,300	12,500	V	C-2R		Brass	B
6	L1040	5.0	1.350	70.0	2,800	1,500	Halogen	C-6	1.6 x 0.7	Brass	A

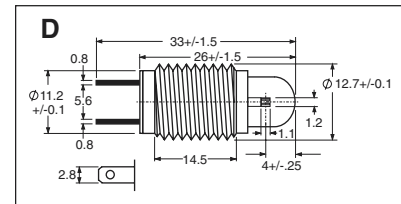

## Precision Half Spherical Lamps

Line No.	Part No.	Volts	Amps	Lumens	Color Temp. Degrees Kelvin	Life Hours	Vacuum Or Gas	Filament Type	Filament Dimensions Lgth. x Dia.	Base Type	Drawing
8	L8010	5.0	0.770	26	2,420	10,000	G	C-6	1.2 x 1.1	½-20 UNF-2A	D
9	L8015	6.0	1.600	75	2,900	150	G	C-6	1.2 x 1.1	½-20 UNF-2A	D